

Peter Kwasny GmbH, Heilbronner Str. 96  
74831 Gundelsheim / Deutschland  
Telefon: +496269 95-0, Fax: +496269 95-80  
www.spraymax.com / www.kwasny.com / info@kwasny.de

**SprayMax®**  
**2K DTM Primer filler 250 ml**  
**Art. Nr. 684260**



## Product

### Description / Purpose

Universal primer filler, can be directly applied to bare metal and all common plastic substrates. Can also be used wet-on wet or as common Primer Filler.

### Properties

- Can be quickly topcoated with all waterborne as well as conventional base- / topcoats
- Fast drying
- Excellent top coat
- Suitable substrate as basis for the Body filler

### Material base

Two-component acrylic resins

Activator: aliphatic isocyanates

### Colour

Light grey

### VOC Value (EU)

607 g/l

## Substrate

Steel (cleaned and sanded)

Galvanised steel (hot-galvanised, strip galvanised and electro-galvanised cleaned and sanded)

Aluminium, soft aluminium (cleaned and sanded)

All conventional plastics separating agent-free, fibre-reinforced plastics (cleaned and sanded)

Polyester surfaces (cleaned and sanded)

E-coat (cleaned and sanded)

Old paint and factory paint (cleaned and sanded)

The damaged area must be dry and free of grease and dust and all rust needs to be removed.

## **Processing**

### **Protection measures**



Wear personal protection equipment.

(respiratory mask/gloves/goggles)

For more information, see safety data sheet.

### **Shake**

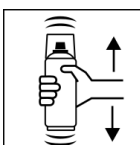

Before activating, shake can thoroughly for 2 minutes from when the mixing balls are heard.

### **Place red button**

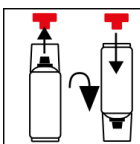

Remove the red button from the cap. Turn the can by 180° and fit the button onto the pin.

### **Press red button**

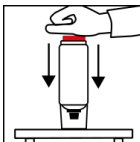

Turn the can upside down and place on a firm surface. Press the red button with the palm of your hand until it clicks into place.

### **Shake**

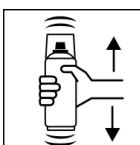

After activating, shake can again thoroughly for 2 minutes, again from when the mixing balls are heard.

### **Adjustable Nozzle**

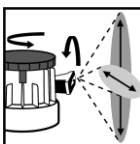

Set the variable spray nozzle to the size and pattern of the damage.

### **Spray to test**

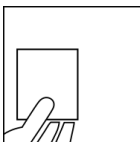

After shaking the can, test spray and check compatibility with the surface and the colour.

### **Spraying distance**

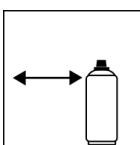

15 cm - 20 cm

## Spray passes

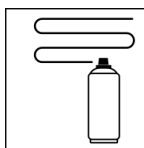

2 spray coats as wet on wet filler each approx 15 µm  
2 - 3 spray coats as sanding filler each approx 15 µm

## Flash-off time

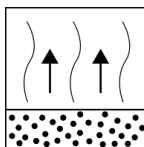

Flash time: approx. 5 - 10 min between each spray coat (until matt)

## Processing conditions

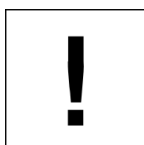

Optimum application at 18° C - 25° C and a relative humidity from 40 - 60 %.

## Coverage

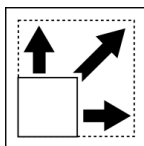

approx. 0,5 m<sup>2</sup> at 50 µm dry film thickness

## Drying

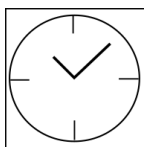

TG1 dust dry: 17 min

TG3 dry to touch: 1,5 h

Ready for sanding: 18 hours at 20°C, 50 min at 60°C

The stated values refer to the above-mentioned processing conditions. The level of dryness is determined pursuant to DIN 53150.



IR: 2 min

Observe equipment description

## Continue

Can be topcoated with all conventional 1K or 2K top coats, and solvent and water-based paints and 2K UP products.

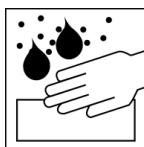

Wet sanding with P 600 - P 800 or  
dry sanding with P 600 - P 1000

## Pot life

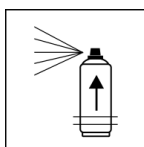

Approx. 8 h at 20° C room temperature and a relative humidity of approx. 40 - 50 %. The processing time depends on the ambient temperature. Higher temperatures reduce the pot life, lower temperatures will prolong it.

## Finish

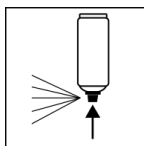

After painting, turn the can upside down and spray the valve until empty.

## Additional Information

### Important Information



Avoid bumps, friction and impact.

### Shelf Life

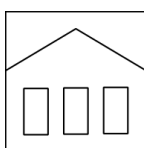

36 months (not activated)

The usage period refers to an unused can that is stored correctly at a temperature of 15 - 25° C and a relative humidity below 60%. The can must be stored and transported in an upright position in a dry place where it is protected against chemical and mechanical influences. The safety information on the can and all statutory provisions applicable for the storage site must be observed.

### Disposal



The completely emptied spray cans must be disposed of in the recycling system. Cans with hardened material must be disposed of as special waste.

### Note

For professional use only.

Identification, see safety data sheet.

The contents in this technical data sheet were created with great care and reflect our current state of knowledge. They provide the user with application-specific information and do not promise certain properties. The information is non-binding and we accept no liability for its integrity, accuracy and completeness. They do not relieve the user of their duty to check the suitability of our product for the intended purpose. The warnings printed on our labels must be respected. Our brands and patents are protected by copyright. All rights reserved We reserve the right to update, amend or supplement the content of the information without prior notice.